

# PACKAGING INFORMATION SHEET



A Product of Atticus, LLC

Product Name:	<b>Castaway</b>
Product SKU:	520043
Package Size:	2 x 1 gal
Product Class:	Herbicide
Active Ingredient:	Imazamox 12.1%
Unit Weight:	19 Lb.
Units Per Pallet:	24 Cases
Full Pallet Weight:	505 Lb.
Density U.S.:	8.80 lb/gal
Special Handling:	Do not Store below 32 degrees Fahrenheit

Warehouse Stacking:	5 high
In Transit Stacking (FTL):	2 high
In Transit Stacking (LTL):	1 high

Stacking heights are guidelines based on engineering designs.  
Always observe safety guidelines during stacking

53' OTR Trailer:	26 pallets
40' Ocean Container:	20 pallets
20' Ocean Container:	10 pallets

Total number of pallets is based on a maximum OTR gross weight limit of 43,600 lb with 26 floor pallet spaces.

\* Unit and full pallet weights represents the net product weight plus all associated packaging weights.

## Unit Dimensions (L x W x H)

10" x 7.75" x 11.5"

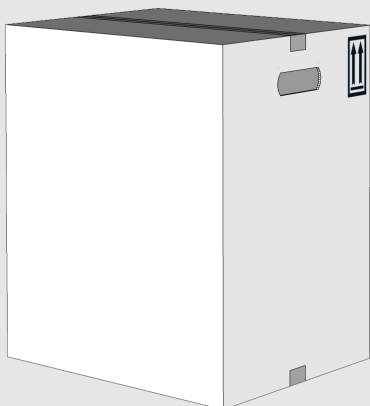

## Full Pallet Dimensions (L x W x H)

48" x 40" x 16"

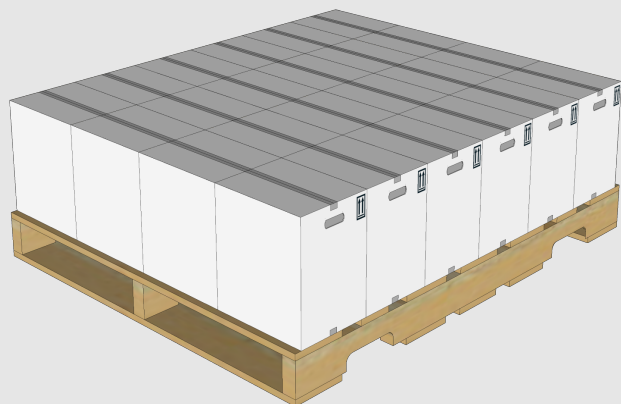

## Required Warehouse Space (L x W x H)

48" x 40" x 80"



For more details around the information provided please contact Atticus, LLC

940 NW Cary Parkway Suite 200 \ Cary, NC 27513 \ ph 984.465.4754 \ f 984.465.4755 \ [www.AtticusLLC.com](http://www.AtticusLLC.com)

Rev: 1/25/2023

# PACKAGING INFORMATION SHEET



A Product of Atticus, LLC

Product Name:	<b>Castaway</b>
Product SKU:	520176
Package Size:	15 gal
Product Class:	Herbicide
Active Ingredient:	Imazamox 12.1%
Unit Weight:	148 Lb.
Units Per Pallet:	9 Drums
Full Pallet Weight:	1,333 Lb.
Density U.S.:	8.80 lb/gal
Special Handling:	Do not Store below 32 degrees Fahrenheit

Warehouse Stacking:	3 high
In Transit Stacking (FTL):	1 high
In Transit Stacking (LTL):	1 high

Stacking heights are guidelines based on engineering designs.  
Always observe safety guidelines during stacking

53' OTR Trailer:	26 pallets
40' Ocean Container:	20 pallets
20' Ocean Container:	10 pallets

Total number of pallets is based on a maximum OTR gross weight limit of 43,600 lb with 26 floor pallet spaces.

\* Unit and full pallet weights represents the net product weight plus all associated packaging weights.

## Unit Dimensions (L x W x H)

14.5" x 26.5"

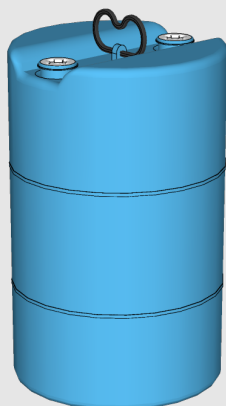

## Full Pallet Dimensions (L x W x H)

45" x 45" x 31"

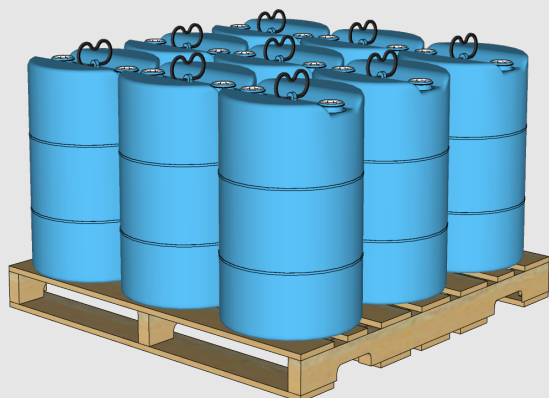

## Required Warehouse Space (L x W x H)

45" x 45" x 93"

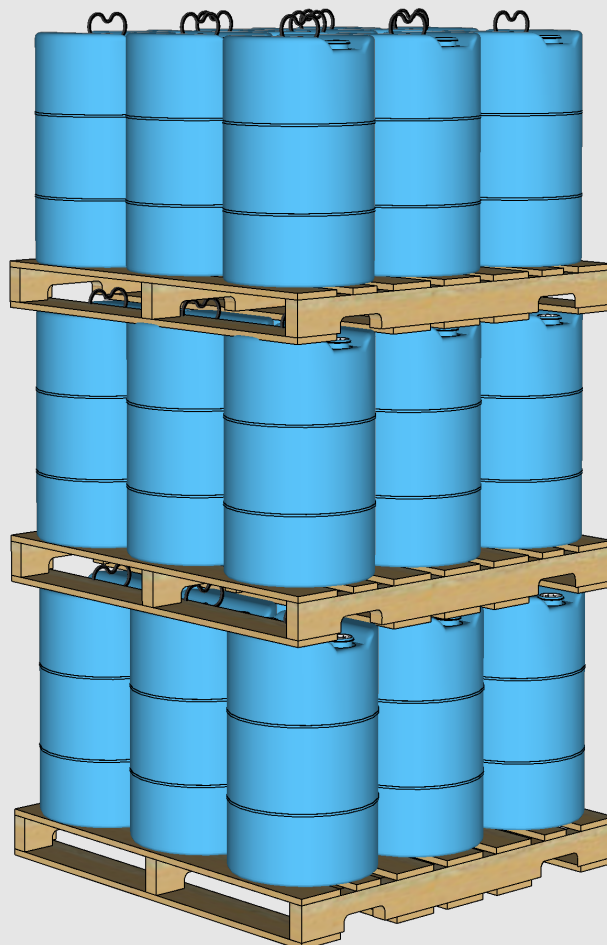

For more details around the information provided please contact Atticus, LLC

940 NW Cary Parkway Suite 200 \ Cary, NC 27513 \ ph 984.465.4754 \ f 984.465.4755 \ [www.AtticusLLC.com](http://www.AtticusLLC.com)

Rev: 10/4/2022