

PACKAGING INFORMATION SHEET

A Product of Atticus, LLC

Product Name:	Pramaxis MEC
Product SKU:	540022
Package Size:	24 x 8 fl oz
Product Class:	Plant Growth Regulator
Active Ingredient:	Trinexapac-ethyl 11.3%
Unit Weight:	15 Lb.
Units Per Pallet:	48 Cases
Full Pallet Weight:	784 Lb.
Density U.S.:	9.10 lb/gal
Special Handling:	

Warehouse Stacking:	3 high
In Transit Stacking (FTL):	2 high
In Transit Stacking (LTL):	1 high

Stacking heights are guidelines based on engineering designs.
Always observe safety guidelines during stacking

53' OTR Trailer:	26 pallets
40' Ocean Container:	20 pallets
20' Ocean Container:	10 pallets

Total number of pallets is based on a maximum OTR gross weight limit of 43,600 lb with 26 floor pallet spaces.

* Unit and full pallet weights represents the net product weight plus all associated packaging weights.

Unit Dimensions (L x W x H)

13.5" x 11.75" x 6.75"

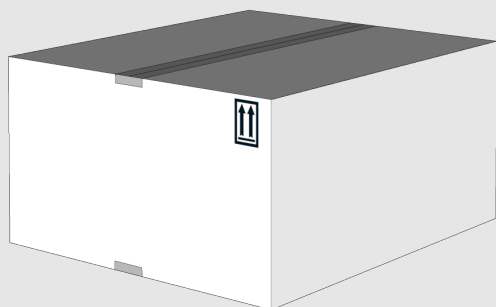

Full Pallet Dimensions (L x W x H)

48" x 42" x 32"

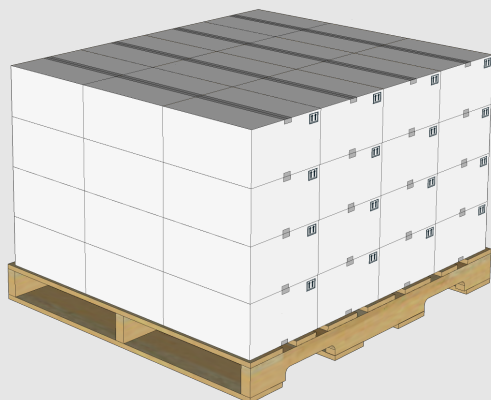

Required Warehouse Space (L x W x H)

48" x 42" x 96"

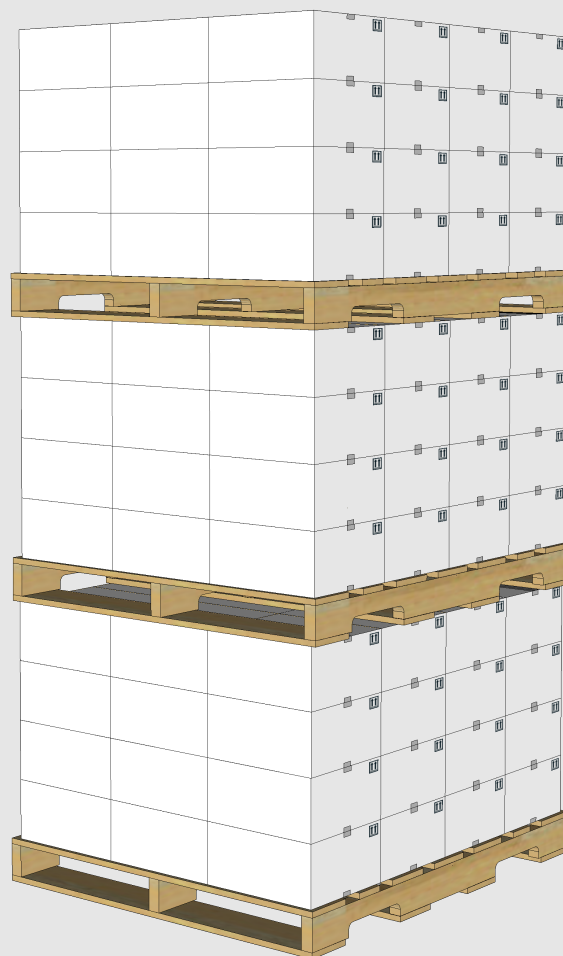

PACKAGING INFORMATION SHEET

A Product of Atticus, LLC

Product Name:	Pramaxis MEC
Product SKU:	540001
Package Size:	2 x 1 gal
Product Class:	Plant Growth Regulator
Active Ingredient:	Trinexapac-ethyl 11.3%
Unit Weight:	20 Lb.
Units Per Pallet:	24 Cases
Full Pallet Weight:	517 Lb.
Density U.S.:	9.06 lb/gal
Special Handling:	None

Warehouse Stacking:	5 high
In Transit Stacking (FTL):	2 high
In Transit Stacking (LTL):	1 high

Stacking heights are guidelines based on engineering designs.
Always observe safety guidelines during stacking

53' OTR Trailer:	26 pallets
40' Ocean Container:	20 pallets
20' Ocean Container:	10 pallets

Total number of pallets is based on a maximum OTR gross weight limit of 43,600 lb with 26 floor pallet spaces.

* Unit and full pallet weights represents the net product weight plus all associated packaging weights.

Unit Dimensions (L x W x H)

10" x 7.75" x 11.5"



Full Pallet Dimensions (L x W x H)

48" x 40" x 16"

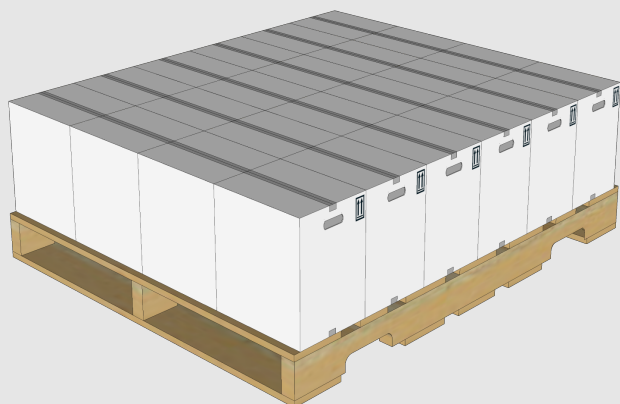

Required Warehouse Space (L x W x H)

48" x 40" x 80"



PACKAGING INFORMATION SHEET

A Product of Atticus, LLC

Product Name:	Pramaxis MEC
Product SKU:	540002
Package Size:	2 x 2.5 gal
Product Class:	Plant Growth Regulator
Active Ingredient:	Trinexapac-ethyl 11.3%
Unit Weight:	49 Lb.
Units Per Pallet:	36 Cases
Full Pallet Weight:	1,796 Lb.
Density U.S.:	9.06 lb/gal
Special Handling:	None

* Unit and full pallet weights represents the net product weight plus all associated packaging weights.

Warehouse Stacking:	3 high
In Transit Stacking (FTL):	1 high
In Transit Stacking (LTL):	1 high

Stacking heights are guidelines based on engineering designs.
Always observe safety guidelines during stacking

53' OTR Trailer:	24 pallets
40' Ocean Container:	20 pallets
20' Ocean Container:	10 pallets

Total number of pallets is based on a maximum OTR gross weight limit of 43,600 lb with 26 floor pallet spaces.

Unit Dimensions (L x W x H)

14.75" x 9.75" x 15"

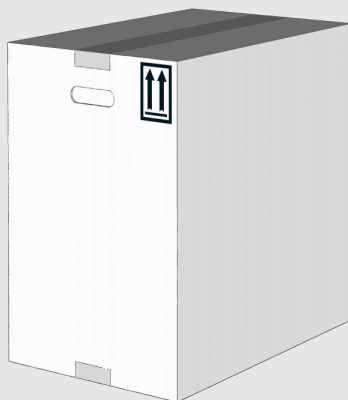

Full Pallet Dimensions (L x W x H)

48" x 40" x 50"



Required Warehouse Space (L x W x H)

48" x 40" x 150"

