

# PACKAGING INFORMATION SHEET



A Product of Atticus, LLC

Product Name:	<b>Tirade CS with EnduraCap Technology</b>
Product SKU:	530089
Package Size:	6 x 1 pt
Product Class:	Insecticide
Product Type:	Capsule Suspension
Unit Weight:	14.0 Lb. / 6.4 Kg
Units Per Pallet:	30 Cases
Full Pallet Weight:	461 Lb. / 209 Kg
Density U.S.:	8.18 or 0.98g/ml
Active Ingredient:	Cyfluthrin 6%

Warehouse Stacking:	3 high
In Transit Stacking (FTL):	2 high
In Transit Stacking (LTL):	1 high

Stacking heights are guidelines based on engineering designs.  
Always observe safety guidelines during stacking

53' OTR Trailer:	26 pallets
40' Ocean Container:	20 pallets
20' Ocean Container:	10 pallets

Total number of pallets is based on a maximum OTR gross weight limit of 42,500 lb with 26 floor pallet spaces.

\* Unit and full pallet weights represents the net product weight plus all associated packaging weights.

Unit Dimensions - 10.875" x 8.75" x 10.25"

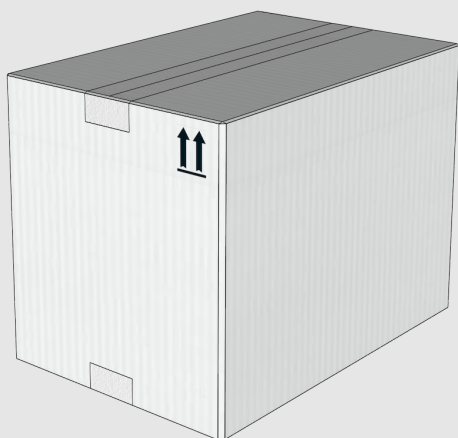

Required Warehouse Space - 36" x 33" x 76.5"



Full Pallet Dimensions - 36.00" x 33.00" x 25.5"

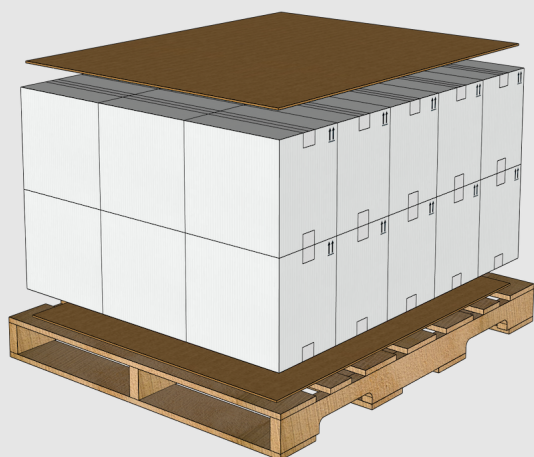

For more details around the information provided please contact Atticus, LLC  
940 NW Cary Parkway Suite 200 \ Cary, NC 27513 \ ph 984.465.4754 \ f 984.465.4755 \ [www.AtticusLLC.com](http://www.AtticusLLC.com)

# PACKAGING INFORMATION SHEET



A Product of Atticus, LLC

Product Name:	<b>Tirade CS with EnduraCap Technology</b>
Product SKU:	530090
Package Size:	4 x 120 fl oz
Product Class:	Insecticide
Product Type:	Capsule Suspension
Unit Weight:	35.5 Lb. / 16.1 Kg
Units Per Pallet:	48 Cases
Full Pallet Weight:	1,747 Lb. / 793 Kg
Density U.S.:	8.18 or 0.98g/ml
Active Ingredient:	Cyfluthrin 6%

\* Unit and full pallet weights represents the net product weight plus all associated packaging weights.

Warehouse Stacking:	3 high
In Transit Stacking (FTL):	1 high
In Transit Stacking (LTL):	1 high

Stacking heights are guidelines based on engineering designs. Always observe safety guidelines during stacking

53' OTR Trailer:	24 pallets
40' Ocean Container:	20 pallets
20' Ocean Container:	10 pallets

Total number of pallets is based on a maximum OTR gross weight limit of 42,500 lb with 26 floor pallet spaces.

Unit Dimensions - 15" x 11.25" x 14"

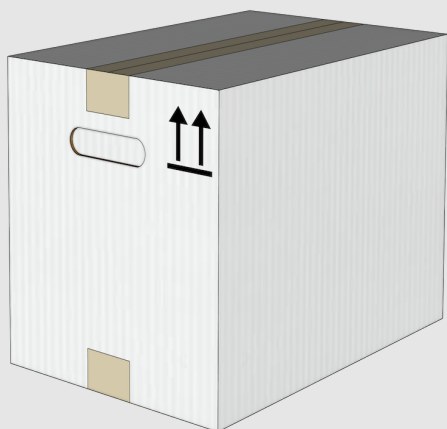

Required Warehouse Space - 45" x 45" x 183"

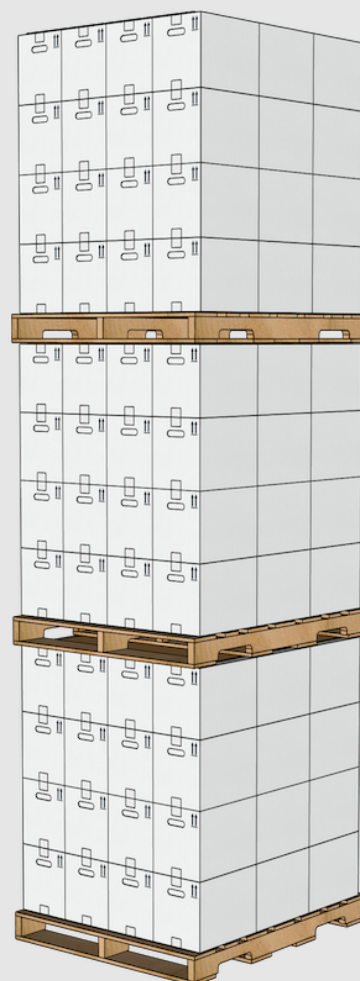

Full Pallet Dimensions - 45" x 45" x 61"

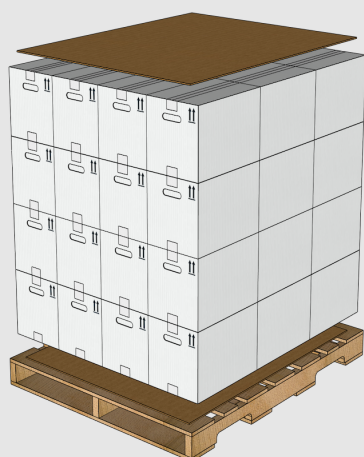

For more details around the information provided please contact Atticus, LLC  
940 NW Cary Parkway Suite 200 \ Cary, NC 27513 \ ph 984.465.4754 \ f 984.465.4755 \ [www.AtticusLLC.com](http://www.AtticusLLC.com)

# PACKAGING INFORMATION SHEET



A Product of Atticus, LLC

Product Name:	<b>Tirade CS with EnduraCap Technology</b>
Product SKU:	530363
Package Size:	30 gal
Product Class:	Insecticide
Product Type:	Capsule Suspension
Unit Weight:	278.1 Lb. / 126.1 Kg
Units Per Pallet:	5 Drums
Full Pallet Weight:	1,436 Lb. / 651 Kg
Density U.S.:	8.14 or 0.98g/ml
Active Ingredient:	Cyfluthrin 6%

Warehouse Stacking:	2 high
In Transit Stacking (FTL):	1 high
In Transit Stacking (LTL):	1 high

Stacking heights are guidelines based on engineering designs.  
Always observe safety guidelines during stacking

53' OTR Trailer:	26 pallets
40' Ocean Container:	20 pallets
20' Ocean Container:	10 pallets

Total number of pallets is based on a maximum OTR gross weight limit of 42,500 lb with 26 floor pallet spaces.

\* Unit and full pallet weights represents the net product weight plus all associated packaging weights.

Unit Dimensions - 19.5" x 29.5"

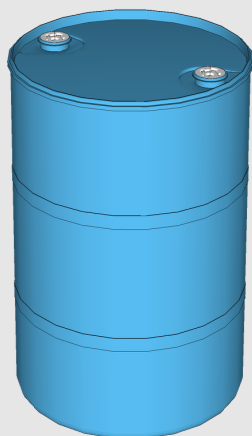

Required Warehouse Space - 48" x 40" x 68"

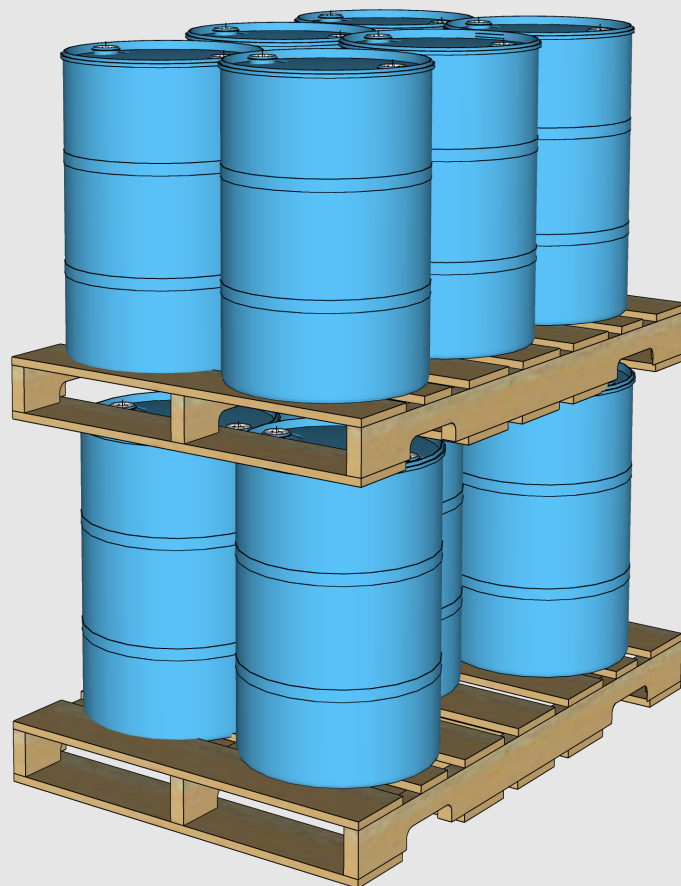

Full Pallet Dimensions - 48" x 40" x 34"

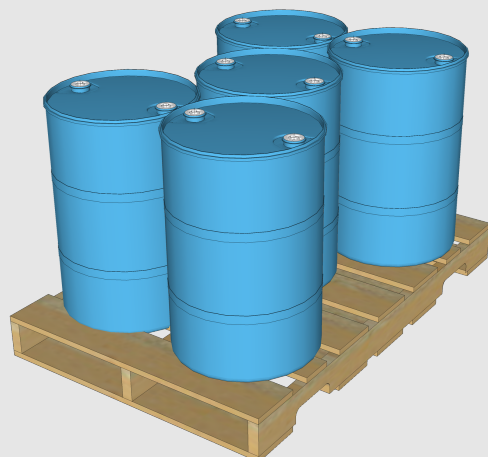

For more details around the information provided please contact Atticus, LLC  
940 NW Cary Parkway Suite 200 \ Cary, NC 27513 \ ph 984.465.4754 \ f 984.465.4755 \ [www.AtticusLLC.com](http://www.AtticusLLC.com)